

## MCAULIFFE - PLAN M6437A3S-0

Total Area: 6437 sq. ft.  
Garage Area: 790 sq. ft.  
Garage Area: 790 sq. ft.  
Garage Size: 3  
Stories: 2  
Bedrooms: 5  
Full Baths: 5  
Half Baths: 2  
Width: 66'-0"  
Depth: 102'-6"  
Height: 25'-3"  
Foundation: Crawl Space



## MCAULIFFE - PLAN M6437A3S-0

### MAIN FLOOR





## MCAULIFFE - PLAN M6437A3S-0

### UPPER FLOOR



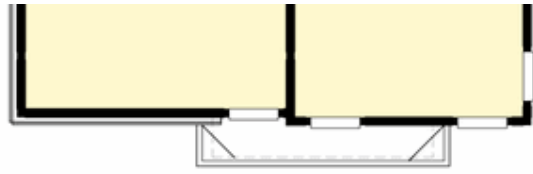

## MCAULIFFE - PLAN M6437A3S-0

### PLAN DETAILS

#### Area Summary

Total Area: 6437 sq. ft.  
Main Floor: 3026 sq. ft.  
Upper Floor: 3411 sq. ft.  
Garage Floor: 790 sq. ft.

#### General Information

Stories: 2  
Width: 66'-0"  
Depth: 102'-6"  
Height: 25'-3"

#### Architectural Style

Contemporary  
Modern  
Prairie

#### Number of Rooms

Bedrooms: 5  
Full Baths: 5  
Half Baths: 2

#### Garage

Garage Size: 3  
Garage Door Location: Side

#### Roof Pitches

Primary: 0:12

#### Wall Heights

Main: 10'-0"  
Upper: 9'-0"

#### Foundation Type

Crawl Space

#### Roof Framing

Stick

#### Floor Load

Live (lbs): 40 PSF  
Dead (lbs): 10 PSF

#### Roof Load

Live (lbs): 25 PSF  
Dead (lbs): 15 PSF  
Wind: 85 MPH

#### Design Features

- Bonus Space @ Upper Floor
- Den/Office
- Front and Rear Porch
- Great Room
- Laundry Room @ Upper Floor
- Luxury Plan
- Master Bedroom @ Upper Floor Rear
- Narrow Lot
- View Lot - Rear