

BRIGHTON - M4552A3S-0

Total Area: **4552 Sq. Ft.**
Garage Area: **903 Sq. Ft.**
Garage Size: **3**
Stories: **2**
Bedrooms : **4**
Full Baths : **3**
Half Baths : **1**
Width : **76`-0"**
Depth : **62`-0"**
Height : **34`-0"**
Foundation : **Crawl Space**



BRIGHTON - M4552A3S-0

MAIN FLOOR

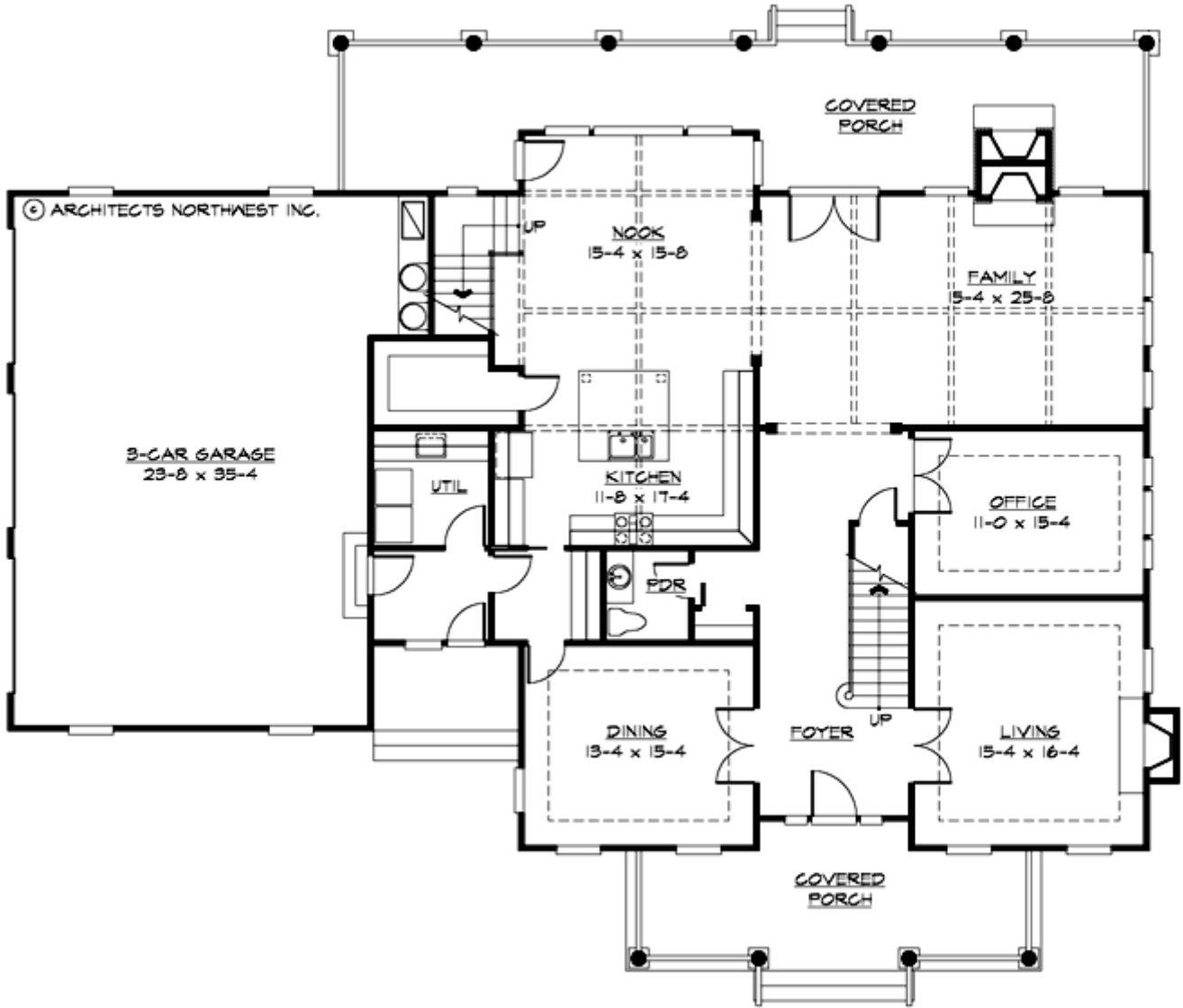

BRIGHTON - M4552A3S-0

UPPER FLOOR

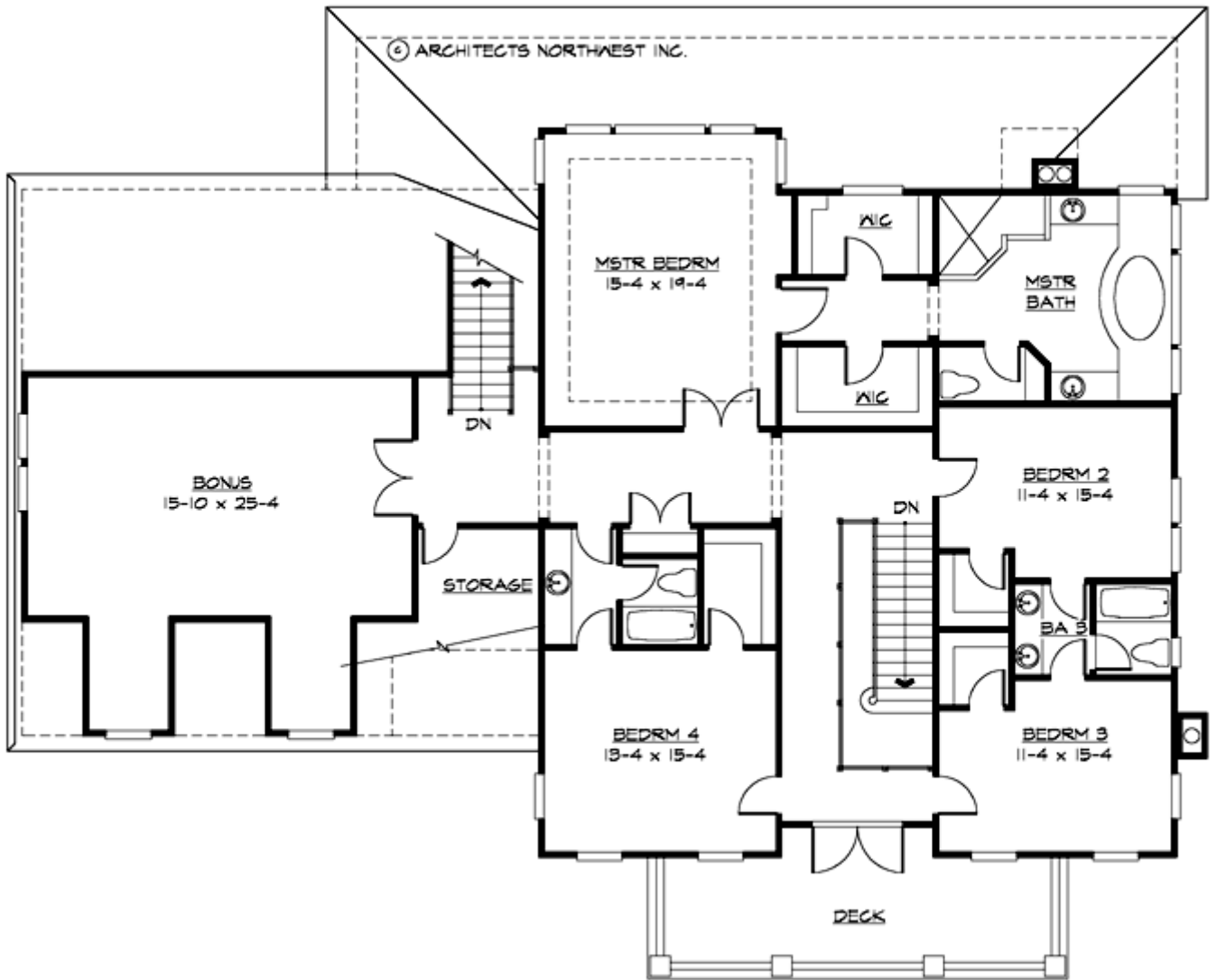

BRIGHTON - M4552A3S-0

PLAN DETAILS

Area Summary

Total Area:	4552 Sq. Ft.
Main Floor:	2157 Sq. Ft.
Upper Floor:	2395 Sq. Ft.
Garage Floor:	903 Sq. Ft.

General Information

Stories:	2
Width:	76`-0"
Depth:	62`-0"
Height:	34`-0"

Architectural Style

Colonial
Country
Farmhouse

Number of Rooms

Bedrooms:	4
Full Baths:	3
Half Baths:	1

Garage

Garage Size:	3
Garage Door Location:	Side

Roof Pitches

Primary:	8:12
Secondary:	12:12

Wall Heights

Main:	9-0"
Upper:	9-0"

Foundation Type

Crawl Space

Roof Framing

Combination

Floor Load

Live (lbs):	40 PSF
Dead (lbs):	10 PSF

Roof Load

Live (lbs):	25 PSF
Dead (lbs):	15 PSF
Wind:	85 MPH

Design Features

- Bonus Space @ & Upper Floor
- Den/Office
- Front Porch
- Great Room
- Laundry Room @ Main Floor
- Master Bedroom @ Upper Floor Rear
- Colonial House Plans
- Country House Plans
- Farmhouse Home Plans
- Wide Lot House Plans