

## **EASTRIDGE - M3260A3F-0**

Total Area: **3260 Sq. Ft.**  
Garage Area: **700 Sq. Ft.**  
Garage Size: **3**  
Stories: **2**  
Bedrooms : **4**  
Full Baths : **2**  
Half Baths : **1**  
Width : **80`-0"**  
Depth : **40`-0"**  
Height : **30`-0"**  
Foundation : **Crawl Space**





# EASTRIDGE - M3260A3F-0

## UPPER FLOOR

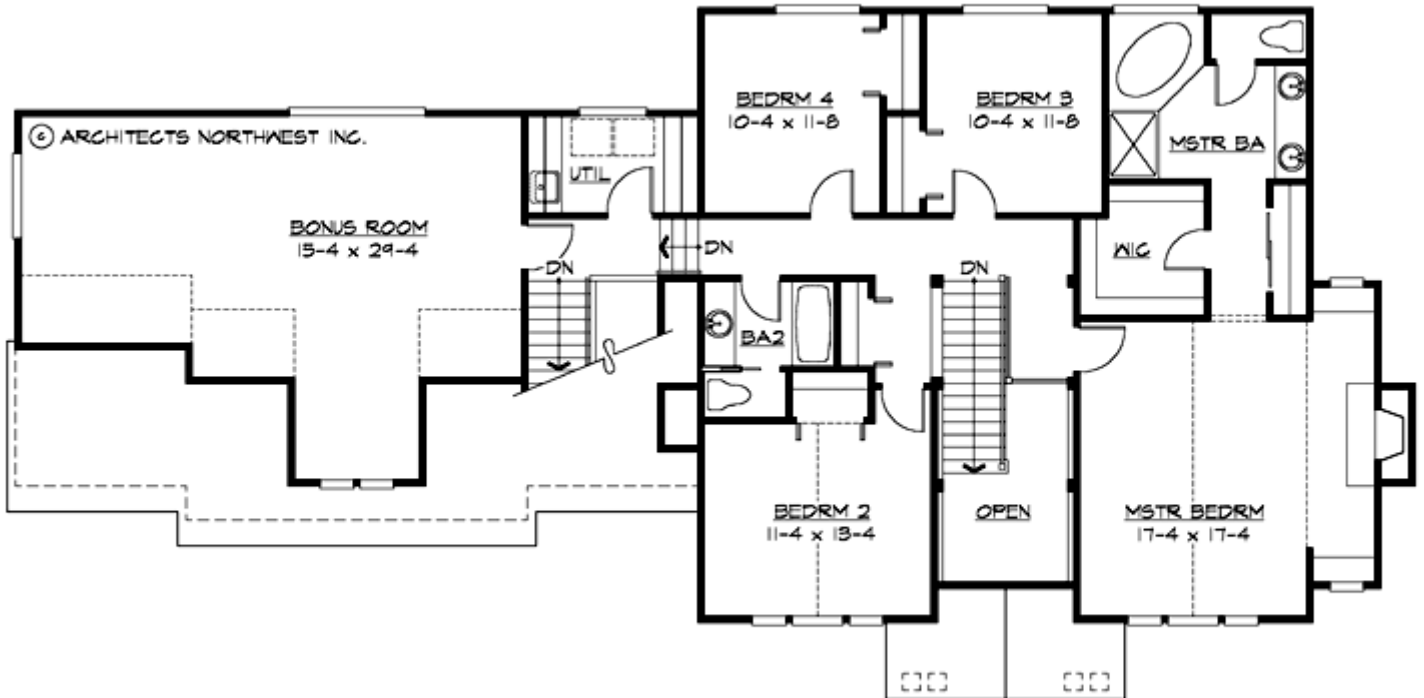

# EASTRIDGE - M3260A3F-0

## PLAN DETAILS

### Area Summary

Total Area:	<b>3260 Sq. Ft.</b>
Main Floor:	<b>1420 Sq. Ft.</b>
Upper Floor:	<b>1840 Sq. Ft.</b>
Garage Floor:	<b>700 Sq. Ft.</b>

### General Information

Stories:	<b>2</b>
Width:	<b>80`-0"</b>
Depth:	<b>40`-0"</b>
Height:	<b>30`-0"</b>

### Architectural Style

Contemporary  
Country  
Farmhouse

### Number of Rooms

Bedrooms:	<b>4</b>
Full Baths:	<b>2</b>
Half Baths:	<b>1</b>

### Garage

Garage Size:	<b>3</b>
Garage Door Location:	<b>Front</b>

### Roof Pitches

Primary:	<b>8:12</b>
----------	-------------

### Wall Heights

Main:	<b>9-0"</b>
Upper:	<b>8-0"</b>

### Foundation Type

Crawl Space

### Roof Framing

Combination

### Floor Load

Live (lbs):	<b>40 PSF</b>
Dead (lbs):	<b>10 PSF</b>

### Roof Load

Live (lbs):	<b>25 PSF</b>
Dead (lbs):	<b>15 PSF</b>
Wind:	<b>85 MPH</b>

### Design Features

- Bonus Space @ & Upper Floor
- Great Room
- Laundry Room @ & Upper Floor
- Master Bedroom @ Upper Floor Front
- Contemporary Home Plans
- Country House Plans
- Farmhouse Home Plans
- View Lot (Front) Plans
- Wide Lot House Plans