

## VERSAILLES - PLAN M4824B3S-1R

Total Area: 4994 sq. ft.  
Garage Area: 699 sq. ft.  
Garage Area: 699 sq. ft.  
Garage Size: 3  
Stories: 2  
Bedrooms: 4  
Full Baths: 4  
Half Baths: 1  
Width: 57'-9"  
Depth: 94'-9"  
Height: 28'-0"  
Foundation: Crawl Space



## VERSAILLES - PLAN M4824B3S-1R

### MAIN FLOOR





## VERSAILLES - PLAN M4824B3S-1R

### UPPER FLOOR



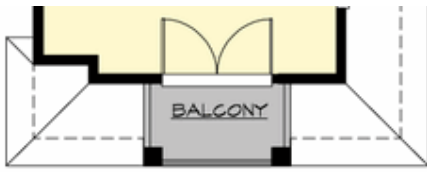

## VERSAILLES - PLAN M4824B3S-1R

### PLAN DETAILS

#### Area Summary

Total Area: 4994 sq. ft.  
Main Floor: 2563 sq. ft.  
Upper Floor: 2431 sq. ft.  
Garage Floor: 699 sq. ft.

#### General Information

Stories: 2  
Width: 57'-9"  
Depth: 94'-9"  
Height: 28'-0"

#### Architectural Style

Chateau  
European  
Traditional

#### Number of Rooms

Bedrooms: 4  
Full Baths: 4  
Half Baths: 1

#### Garage

Garage Size: 3  
Garage Door Location: Side

#### Roof Pitches

Primary: 5:12  
Secondary: 3:12

#### Wall Heights

Main: 10'-0"  
Upper: 9'-0"

#### Foundation Type

Crawl Space

#### Roof Framing

Trusses

#### Floor Load

Live (lbs): 40 PSF  
Dead (lbs): 10 PSF

#### Roof Load

Live (lbs): 25 PSF  
Dead (lbs): 15 PSF  
Wind: 85 MPH

#### Design Features

- Bonus Space @ Upper Floor
- Den/Office
- Front and Rear Porch
- Great Room
- Laundry Room @ Main Floor
- Luxury Plan
- Master Bedroom @ Upper Floor Rear
- View Lot - Front